

Geo. Ryon.

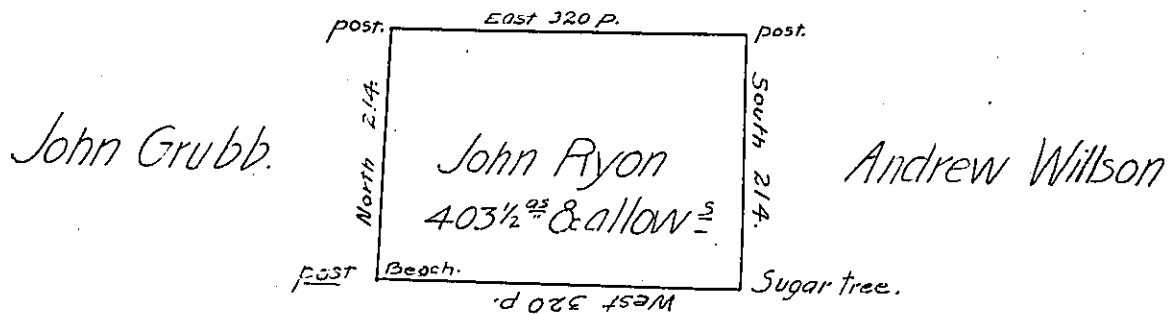

Henry Ryon.

A Draft of a tract of land Called — Situate on the Waters of Coniatt Creek in the County of Allegany adjoining Land of Henry ^{Ryon} & others Survey^d the 6th day of July 1795. in Pursuance of an Improvement, dated the 10th day of March 1795. Containing 403 1/2 acres & allowance &c.

tho^s Rees D.S.

to Dan^l Brodhead Esquire.
Surveyor Gen^l

IN TESTIMONY that the above is a copy of the original remaining on file in the Department of Internal Affairs of Pennsylvania, made conformably to an Act of Assembly approved the 16th day of February, 1833, I have hereunto set my Hand and caused the Seal of said Department to be affixed at Harrisburg, this fourteenth day of August 1906.

Loae B. Brown
Secretary of Internal Affairs.